

10. Place shelf onto hardware.
11. Secure shelf using #4 3/4in. screws at all hardware locations.

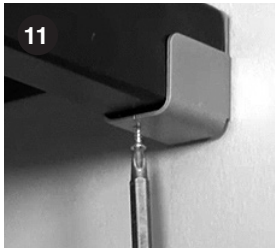
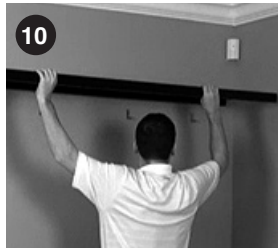

# JOHN LOUIS HOME

Solid Wood Home Storage Solutions

## Installation Instructions Shelf End Hardware

JLH-511WC

Shelf End Brackets are designed to be installed onto the front ends of the shelf rails only in order to support and attach the shelf to a sidewall, tower or rail face of perpendicular shelf.

### PARTS LIST:



Quantity: 4  
Shelf End



Quantity: 8  
#8 1 1/2in. Screw



Quantity: 4  
#4 3/4in. Screw



Quantity: 8  
Wall Anchor

### CONTACT US:

For questions concerning missing or damaged parts, technical specs and / or assembly help, please contact John Louis Home Customer Service at:

[service@johnlouishome.com](mailto:service@johnlouishome.com) 1.800.480.6985 (M-F 8am-4pm CST)

## STEP 1:

---

1. Place shelf onto L clip hardware.
2. Place Shelf End hardware onto end of shelf.

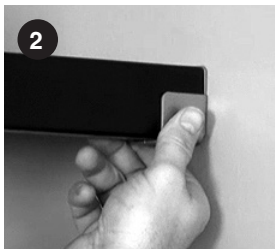
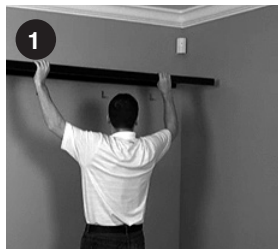

3. Place level onto shelf & level shelf front to back.
4. Mark Shelf End hardware location.
5. Remove Shelf.



6. Place Shelf End hardware at marked location & mark screw hole locations.
7. Install wall anchors if no stud is present.

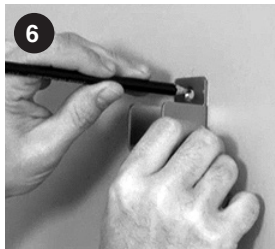

8. Secure Shelf End to the wall using # 8 1 1/2 in. screws at hole locations.
9. Repeat for other Shelf End locations.

